

MANDREX - THE FASTEST SYSTEM EVER

MX QUICK CHANGE ARBOR



Mandrex Hole Saw System
Tuindersweg 28-B
2676 BH Maasdijk
The Netherlands
Tel: +31 174 528 077
www.mandrex-system.com
sales@mandrex-system.com



ONLY
OUTSIDE
EUROPE

IT'S NEW, IT'S FAST QUICK CHANGE

Mandrex MX makes life easy. All you have to do is push the button, slide back the adapter and remove the core. Compared to standard saws, changing saws with Mandrex MX is better, faster and more efficient.

The system is very flexible and friendly to use. You can enlarge the centre drill easily by sliding the MX adapters against the drill-chuck. Replacing the Hole Saw is a matter of pushing the button, remove the hole saw with adapter and slide on another hole saw with adapter with the correct diameter hole saw.

Try the revolutionary easy Mandrex MX Hole Saw system for a change.

It changes your business very quickly!

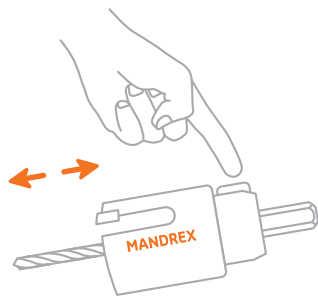

1

Replace the hole saw easily

To remove the Hole Saw to use another diameter, just push the button and remove the whole system. Slide on another system with the correct diameter Hole Saw.



2

Drop out the plug with one "click"

Just Push the button, slide back the adapter and remove the core. It's fast, saves money and time wasting.

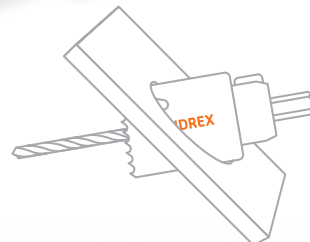

3

Drill holes at an angle, including the big ones!

You can drill at an angle even with large hole saws. Because of the flexibility of the system you can enlarge the centre drill. Just slide the MX adapters against the drill-chuck.



4

Enlarge already drilled holes

It is now solved! Just use the too small drilled hole saw as a centre drill. Pull it into the hole, centre the new one, click off the small one and finish the big one.

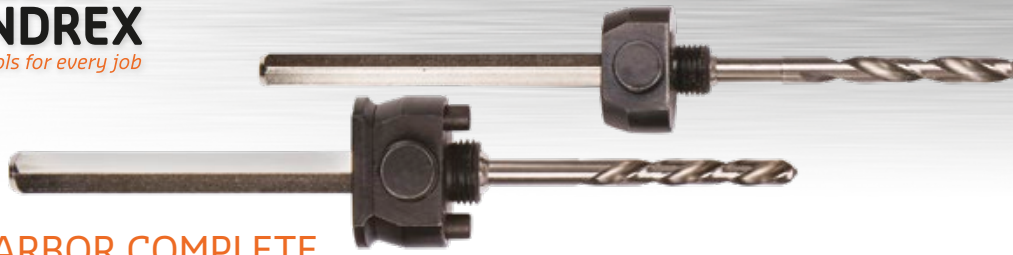

MX ARBOR COMPLETE

MX20001B	MX Arbor Complete (Hole Saws Ø32 mm and larger) for MP Carbide Tipped, M3 & M42 Bi-Metal Holesaws	Drill Chuck Ø13 mm / Hex 10 Thread 5/8" - 18 UNF	Set includes MX2P1001 + MX2P1010
MX20001CB	MX Arbor Complete (Hole Saws Ø32 mm and larger) for MP Carbide Tipped Hole Saws - Carbide tip centre drill	Drill Chuck Ø13 mm / Hex 10 Thread 5/8" - 18 UNF	Set includes MX2P1001 + MX2P1011
MX200010B	MX arbor Complete (Hole Saws Ø32 mm and larger) for HSS Bi-Metal hole saws (short)	Drill Chuck Ø13 mm / Hex 10 Thread 5/8" - 18 UNF	Set includes MX2P1001 + MX2P1014
MX200002B	MX Arbor Complete (Hole Saws Ø15 mm - Ø30 mm) for MP Carbide Tipped, M3 & M42 Bi-Metal Holesaws	Drill Chuck Ø10 mm / Hex 10 Thread 1/2" - 20 UNF	Set includes MX2P1003 + MX2P1020
MX200002CB	MX Arbor Complete (Hole Saws Ø15 mm - Ø30 mm) for MP Carbide Tipped Hole Saws - Carbide tip centre drill	Drill Chuck Ø10 mm / Hex 10 Thread 1/2" - 20 UNF	Set includes MX2P1003 + MX2P1021
MX200011B	MX Arbor Complete (Hole Saws Ø15 mm - Ø30 mm) for HSS Bi-Metal hole saws (short)	Drill Chuck Ø10 mm / Hex 10 Thread 1/2" - 20 UNF	Set includes MX2P1003 + MX2P1024



MX ADAPTERS

MX2P1001B	MandreX MX adapter with retraction ring	Hex 10 - Thread 5/8" - 18 UNF
MX2P1001iB	MandreX MX adapter without retraction ring	Hex 10 - Thread 5/8" - 18 UNF
MX2P1003B	MandreX MXs adapter	Hex 8 - Thread 1/2" - 20 UNF
MX2P1002B	MandreX MXs adapter (Hole enlargement)	Hex 8 - Thread 5/8" - 18 UNF

MX PILOT DRILLS



MX2P1010B	Pilot drill HSS (Long) - for MP Carbide Tipped, M3 & M42 Bi-Metal Hole Saw	Drill Chuck Ø13 mm / Hex 10 135 degrees Split Point	For e.g. wood, plastics
MX2P1014B	Pilot drill HSS (Short) for short HSS Bi-Metal Hole Saws	Drill Chuck Ø13 mm / Hex 10 135 degrees Split Point	For e.g. wood, plastics
MX2P1011B	Pilot drill Carbide Tipped for Multi Purpose Hole Saws	Drill Chuck Ø13 mm / Hex 10 Multi Purpose Hole Saws	For e.g. concrete, (sand-)stone
MX2P1020B	Pilot drill HSS (Long) for MP Carbide Tipped, M3 & M42 Bi-Metal Hole Saws	Drill Chuck Ø10 mm / Hex 8 135 degrees Split Point	For e.g. wood, plastics
MX2P1024B	Pilot drill HSS (Short) for short HSS Bi-Metal Hole Saws	Drill Chuck Ø10 mm / Hex 8 135 degrees Split Point	For e.g. wood, plastics
MX2P1021B	Pilot drill Carbide Tipped for Multi Purpose Hole Saws	Drill Chuck Ø10 mm / Hex 8 Percussion drill tip	For e.g. concrete, (sand-)stone